

CONSTRUCTION PLANS

FOR

BLOWER AND SWITCHGEAR BUILDING EPA PROJECT NO. C380 325-03

MANDAN, NORTH DAKOTA

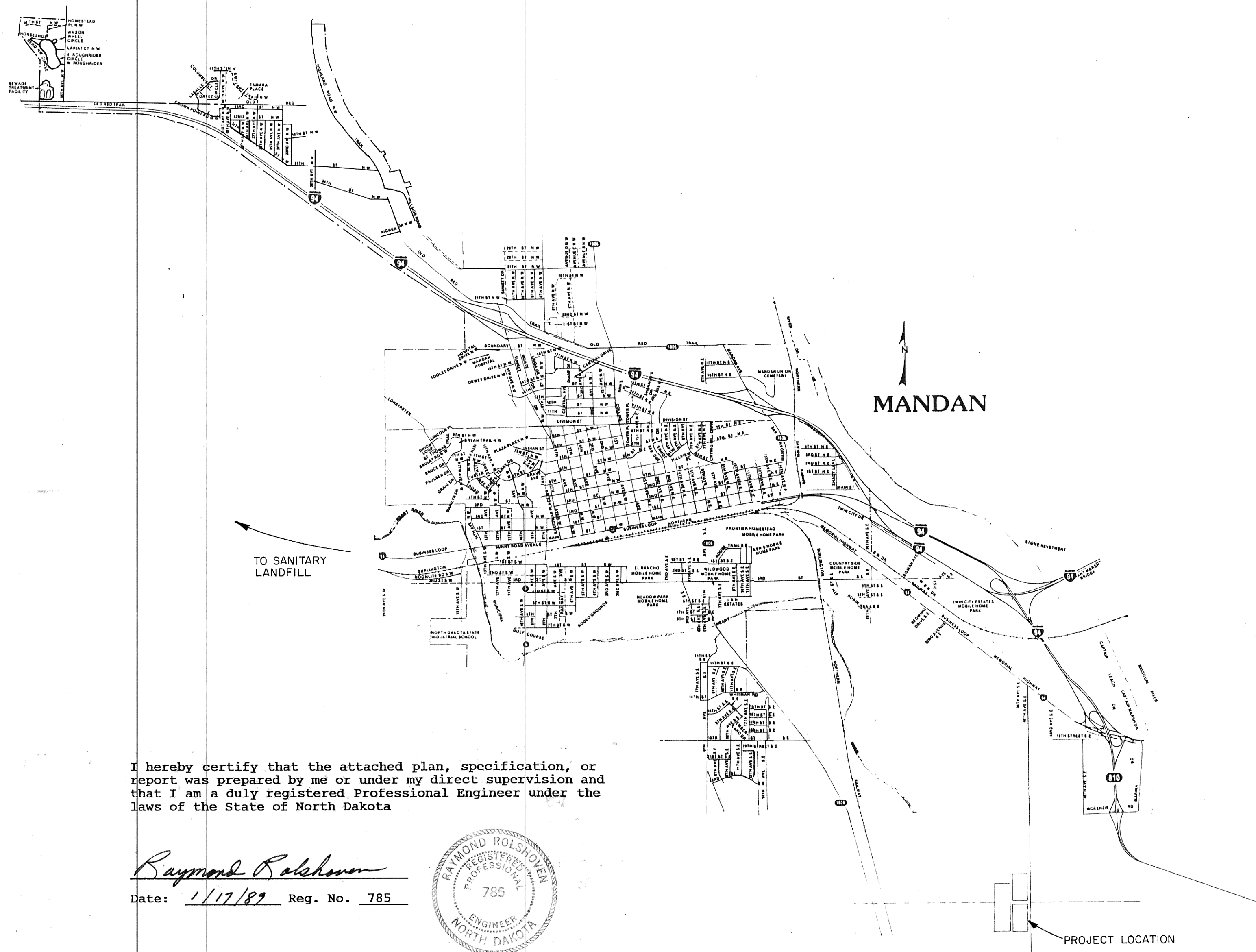

I hereby certify that the attached plan, specification, or report was prepared by me or under my direct supervision and that I am a duly registered Professional Engineer under the laws of the State of North Dakota

Raymond Rolfskovien
Date: 1/17/89 Reg. No. 785

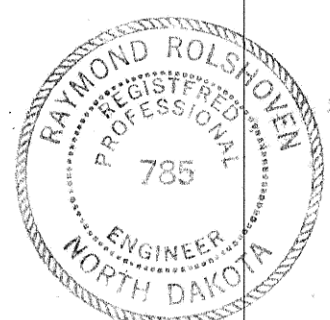

Brandt Madsen
Date: 1/17/89 Reg. No. 2847



Robert S. Granlund
Date: 1/17/89 Reg. No. 2320

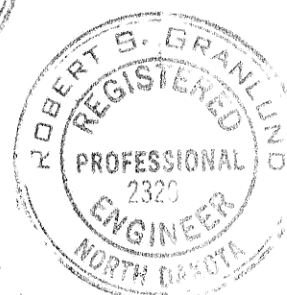

I hereby certify that the attached plan, specification, or report was prepared by me or under my direct supervision and that I am a duly registered Architect under the laws of the State of North Dakota

Al E. Filler
Date: 1/17/89 Reg. No. 507

APPROVED BY *Thomas E. Balle*
MANDAN CITY ENGINEER

- LEGEND**
- x-x- = FENCE
 - = HEADER CURB
 - ⊕ = BORING LOCATION
 - ← = GUY WIRE
 - 45.69 = SPOT ELEVATION (EA-EDGE ASPHALT) (TC-TOP OF CURB)
 - I+00 = SURVEY Q. STATION
 - = AIR PIPING
 - ▭ = BUILDING
 - 6"W--- = EXISTING WATERLINE
 - ⊙ = VALVE
 - = MAN HOLE
 - ⊕ = POWER POLE
 - OH--- = OVERHEAD POWER
 - UG--- = UNDERGROUND POWER
 - G--- = GAS LINE

INDEX FOR PLAN SHEETS

CIVIL		
BLOWER AND AERATOR CONTROL BUILDINGS SITE PLANS	C-1	
AIR PIPING SYSTEM	C-2	
CONCRETE AND ASPHALT SURFACE DETAILS	C-2	
ARCHITECTURAL		
BLOWER BUILDING	A-1	
STRUCTURAL		
BLOWER BUILDING	S-1	
AERATOR CONTROL BUILDING	S-2	
PROCESS		
BLOWER BUILDING	P-1	
ELECTRICAL		
BLOWER BUILDING	E-1	
AERATOR CONTROL BUILDING	E-2	
DETAILS		
	D-1	

SUMMARY OF QUANTITIES

ITEM NO.	DESCRIPTION	UNIT	BID QUANTITY	INSTALLED QUANTITY
1	Asphalt Pavement			
	a. Gravel Base	TON	40	39.5
	b. Asphalt Pavement CONCRETE	SF	1192	1192
	c. Seal Coat and Chips	SF	140	
2	Concrete Sidewalk	SF	160	134
3	Sewermain			
	a. 6" PVC SDR 35	LF	150	152
	b. Subcut Gravel	TON	30	0
	c. Rock Excavation	CY	30	0
4	Seeding			
	a. Class II	SY	1250	2352
5	Blower and Switchgear Building	LS	1	1
6	Aerator Control Building	LS	1	1
7	Butterfly Valves			
	a. 14" Valve With Valve Box and Cover	EA	2	2
	b. 4" Valve Without Valve Box	EA	3	3
8	Air Piping			
	a. 18" Steel Air Pipe	LF	290	281
	b. 4" Steel Air Pipe	LF	55	48

ULTEIG ENGINEERS INC.

Bismarck, Fargo and Minot, North Dakota and Minneapolis, Minnesota

89-2