

INSTALLED PIPING & FITTING DETAILS

- NOTES**
- INTERIOR WALLS & ROOF SHALL BE P.V.C. LINED DOWN TO ELEV. 1620.50
  - FURNISH & INSTALL A 3/4" STEEL BASE PLATE. PLATE SHALL BE AT LEAST 2 1/2" WIDER THAN THE MANUFACTURERS RECOMMENDED BOLT DIMENSIONS - BOTH WAYS. PLATE SHALL BE LEVELED FOR MOUNTING THE DISCHARGE ELBOW.

**SUMMARY OF QUANTITIES**

LIFT STATION	1 L.S.
10" D.I. FORCEMAIN	27 58' L.F.
10" 1/4 BEND	2 EA.
24" M.J. BUTTERFLY VALVE	2 EA.
24" M.J. TEE	1 EA.
24" CONCRETE TO D.I. TRANSITION SECTION	2 EA.
24" D.I. PIPE	16.75 30' L.F.
MANHOLE	1 EA.
SEEDING	0.40 15' AC.
10x8" M.J. REDUCER	2 EA.
8" D.I. FORCEMAIN	10 L.F.

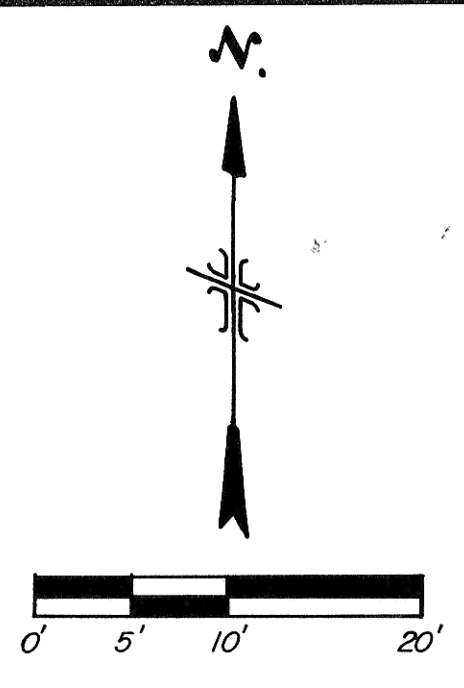

NOTE: Contractor to field verify location of all underground utilities prior to construction.

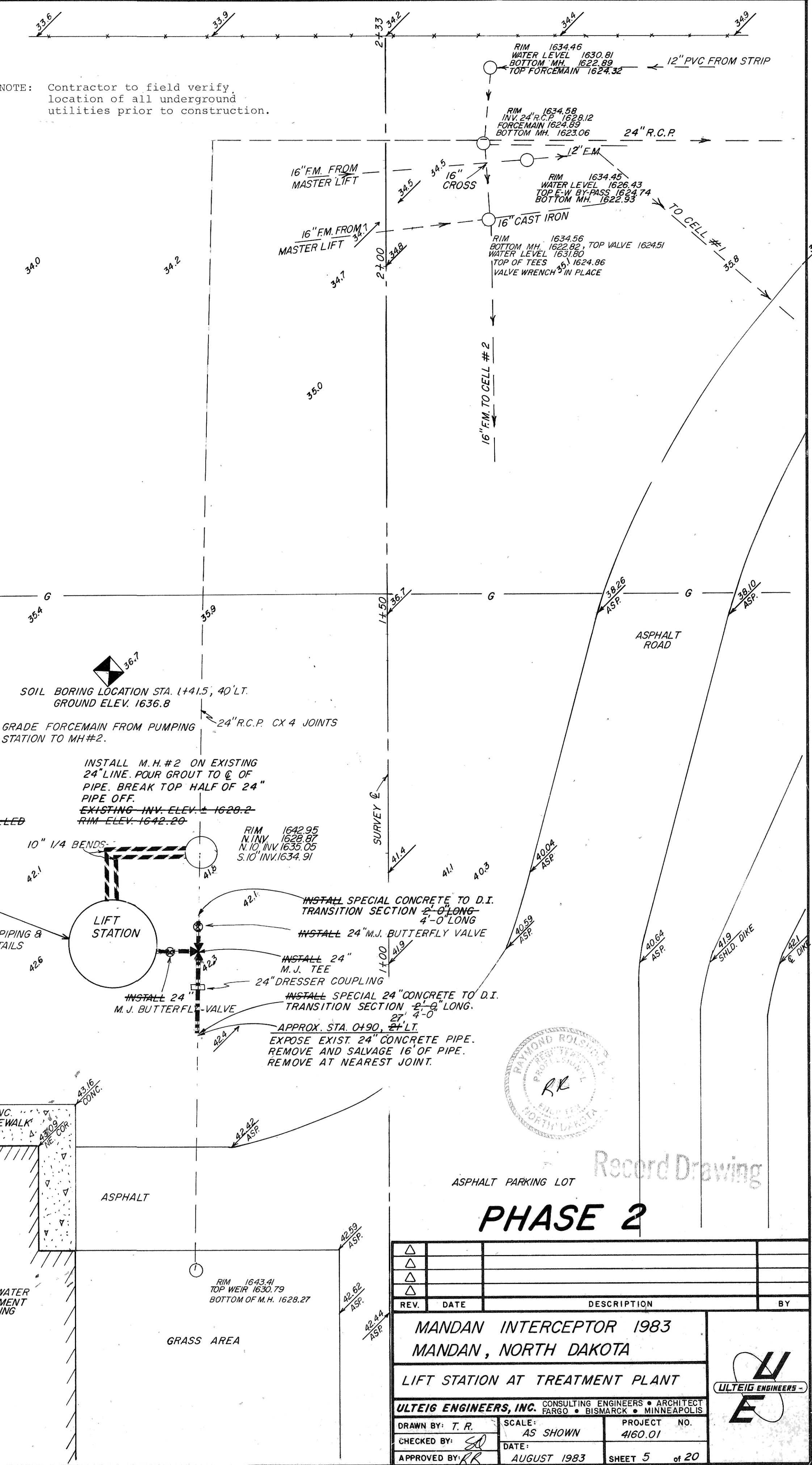

SOIL BORING LOCATION STA. (41.5, 40' LT. GROUND ELEV. 1636.8)

NOTE: GRADE FORCEMAIN FROM PUMPING STATION TO MH#2.

INSTALL M.H.#2 ON EXISTING 24" LINE. POUR GROUT TO 1/2 OF PIPE. BREAK TOP HALF OF 24" PIPE OFF. EXISTING INV. ELEV. 1620.2 RIM ELEV. 1642.20

NOTE: BOTH 10" P.V.C. TO BE INSTALLED IN SAME TRENCH.

INSTALL 24" M.J. BUTTERFLY VALVE

INSTALL 24" M.J. TEE

INSTALL 24" CONCRETE TO D.I. TRANSITION SECTION 4'-0" LONG.

APPROX. STA. 0490, 24' LT. EXPOSE EXIST. 24" CONCRETE PIPE. REMOVE AND SALVAGE 16' OF PIPE. REMOVE AT NEAREST JOINT.

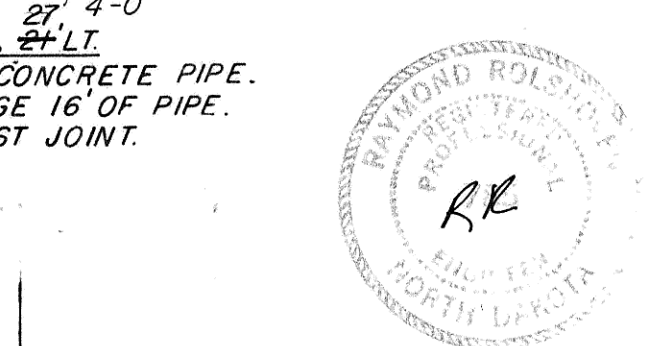

Record Drawing

## PHASE 2

MANDAN INTERCEPTOR 1983  
MANDAN, NORTH DAKOTA

LIFT STATION AT TREATMENT PLANT

ULTEIG ENGINEERS, INC. CONSULTING ENGINEERS & ARCHITECTS  
FARGO • BISMARCK • MINNEAPOLIS

REV.	DATE	DESCRIPTION	BY

DRAWN BY: T. R. SCALE: AS SHOWN PROJECT NO. 4160.01  
CHECKED BY: DATE: AUGUST 1983  
APPROVED BY: KR SHEET 5 of 20