

HELMSWORTH & Mc LEAN'S ADD.

NOTE: Contractor to field verify location of all underground utilities prior to construction.

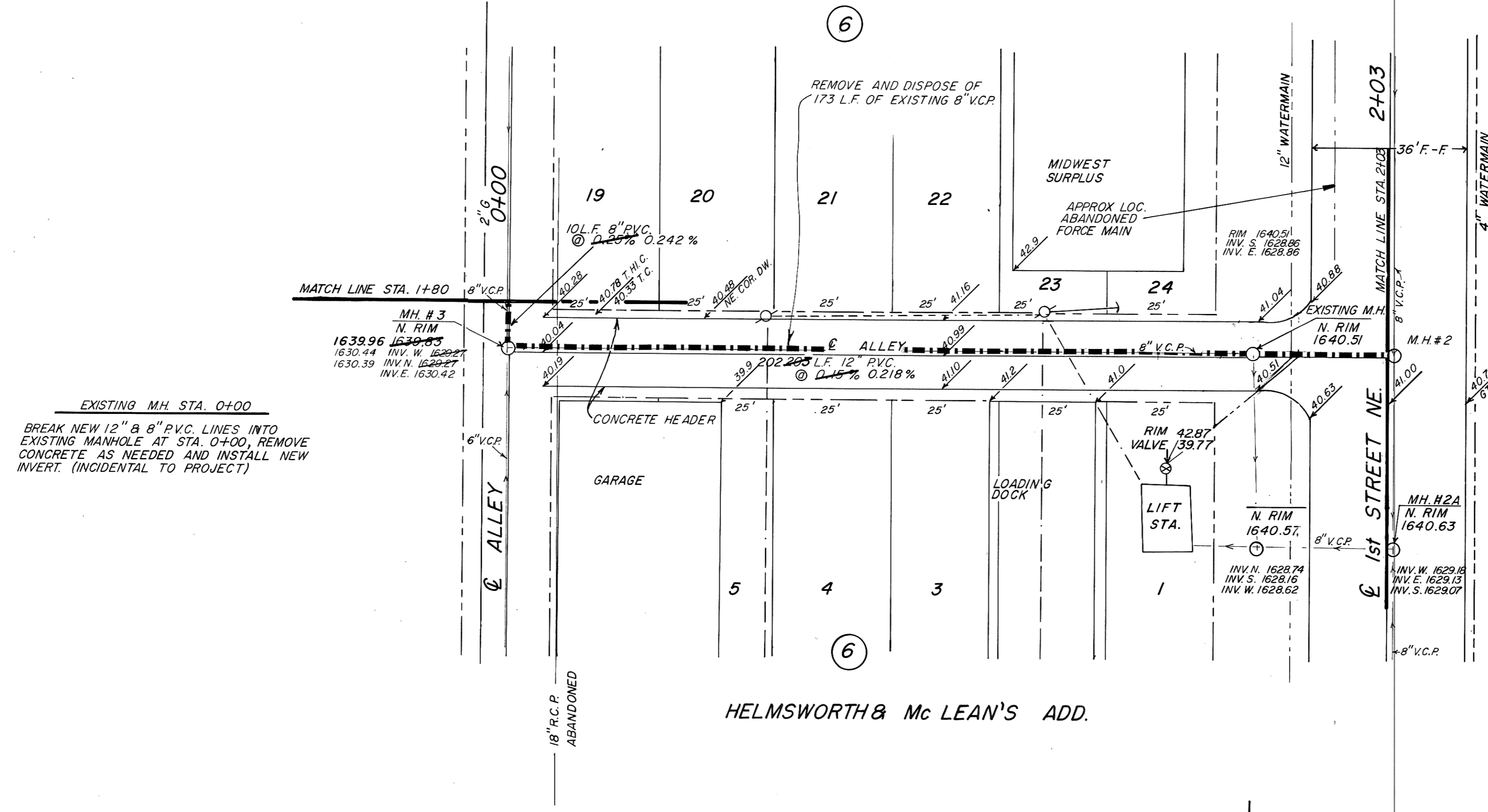
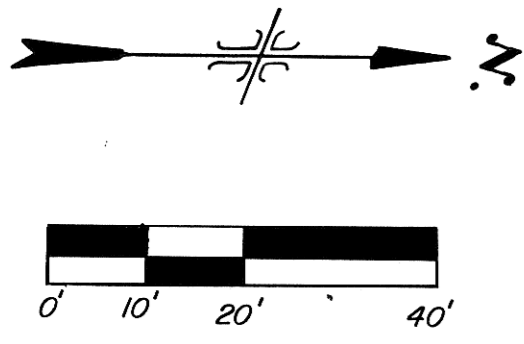

EXISTING MH STA. 0+00
BREAK NEW 12" & 8" PVC LINES INTO EXISTING MANHOLE AT STA. 0+00, REMOVE CONCRETE AS NEEDED AND INSTALL NEW INVERT. (INCIDENTAL TO PROJECT)

REMOVE EXISTING MANHOLE AT STA. 1+72, SALVAGE TO BE DELIVERED TO CITY OF MANDAN. PLUG LINE TO EAST WITH GROUT. (INCIDENTAL TO PROJECT)

REMOVE AND REPLACE ASPHALT 12' X 213' 204 S.Y.
10.5' X 202' = 236 S.Y.
10' X 11' = 12 S.Y.

REMOVE AND REPLACE 10 L.F. OF CURB & GUTTER AT STA. 1+85

SEWER SERVICE LOCATIONS
0+34.5 EAST

SUMMARY OF QUANTITIES	
12" P.V.C. SEWER	202 L.F. 202 L.F.
ASPHALT REMOVAL & REPLACEMENT	204 S.Y. 248 S.Y.
8" P.V.C. SEWER	10 L.F.
SEWER PIPE REMOVAL	236 L.F. 183 L.F.
RECONNECT SEWER SERVICES	1 Ea. 1 Ea.
4" SEWER SERVICE PIPE	24 L.F. 3 L.F.
REMOVE & REPLACE CURB & GUTTER	10 L.F.

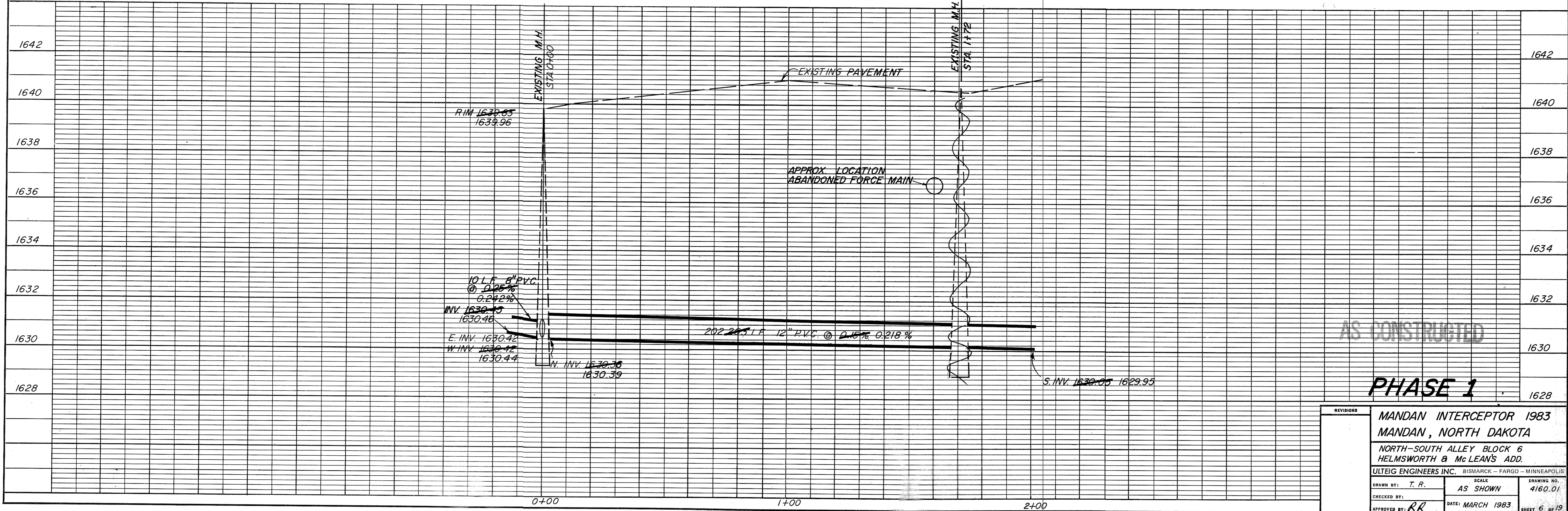

AS CONSTRUCTED

PHASE 1

REVISIONS	MANDAN INTERCEPTOR 1983 MANDAN, NORTH DAKOTA	
	NORTH-SOUTH ALLEY BLOCK 6 HELMSWORTH & Mc LEAN'S ADD.	
	ULTEIG ENGINEERS INC. BISMARCK - FARGO - MINNEAPOLIS	
DRAWN BY: T. R.	SCALE: AS SHOWN	DRAWING NO. 4160.01
CHECKED BY:	DATE: MARCH 1983	SHEET 6 OF 19
APPROVED BY: RR		