

HORZ 1" = 100'
VERT 1" = 20'

DATE	DESIGNED BY	DESCRIPTION
	CITY OF MANDAN, NORTH DAKOTA	
	ENGINEERING DEPARTMENT	
W.M. installation from existing S.I.S. 8" W.M. SOUTH along Levee to connect existing N.B.R.R.C. 8" W.M.		
DRAWN BY	DATE	SCALE
J.W. LITTLE	10/25/06	AS SHOWN
PROJECT NO.	DISTRICT NO.	SHEET NO.
85-2	9	7 OF 10

AS BUILT

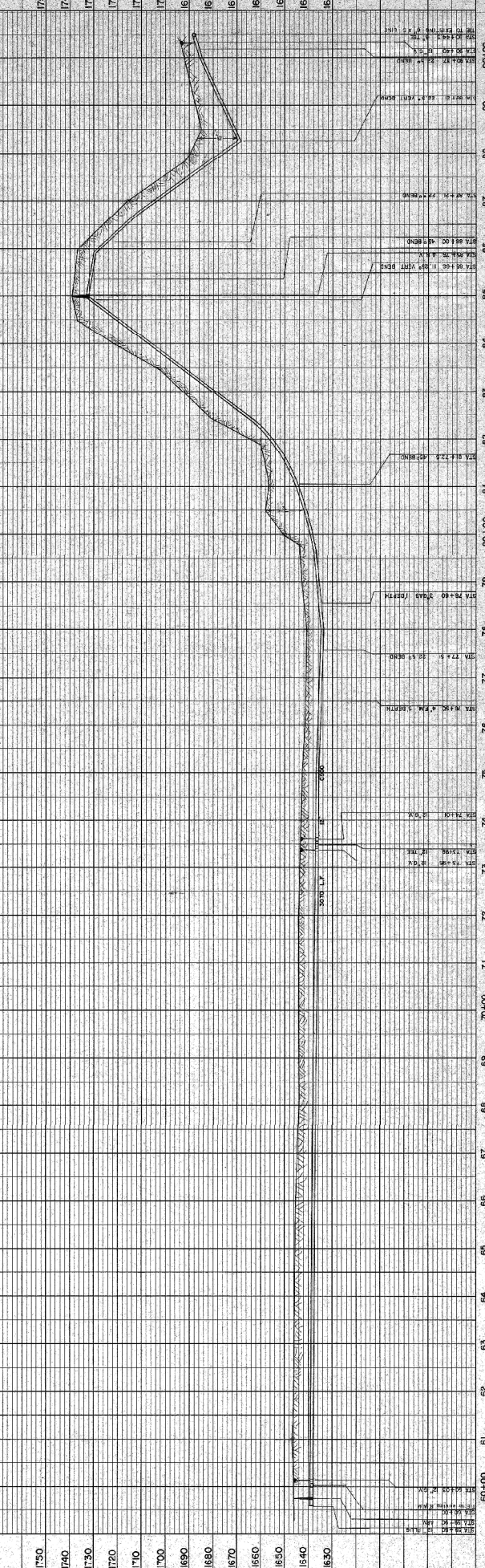

STATION	ELEVATION	DESCRIPTION
60+00	1630	GRAVEL
60+00	1635	GRAVEL
60+00	1640	GRAVEL
60+00	1645	GRAVEL
60+00	1650	GRAVEL
60+00	1655	GRAVEL
60+00	1660	GRAVEL
60+00	1665	GRAVEL
60+00	1670	GRAVEL
60+00	1675	GRAVEL
60+00	1680	GRAVEL
60+00	1685	GRAVEL
60+00	1690	GRAVEL
60+00	1695	GRAVEL
60+00	1700	GRAVEL
60+00	1705	GRAVEL
60+00	1710	GRAVEL
60+00	1715	GRAVEL
60+00	1720	GRAVEL
60+00	1725	GRAVEL
60+00	1730	GRAVEL
60+00	1735	GRAVEL
60+00	1740	GRAVEL
60+00	1745	GRAVEL
60+00	1750	GRAVEL

PROJECT 85-
SHEET 7 OF 10

DATE	BY	CHKD.
APPROVED	DATE	SCALE

DATE	BY	CHKD.