

- CONSTRUCTION NOTES**
- UTILITY LOCATIONS SHOWN ON THE PLANS ARE APPROXIMATE. THE CONTRACTOR SHALL BE RESPONSIBLE FOR LOCATING ALL UTILITIES PRIOR TO ANY CONSTRUCTION ACTIVITY. THE NORTH DAKOTA "ONE-CALL" NUMBER IS 1-800-795-0555.
 - APPROXIMATE TOP OF ROAD SUBGRADE SHALL BE BY OTHERS, PRIOR TO CONSTRUCTION. CONTRACTOR WILL HAVE TO SHAPE SUBGRADE AS REQUIRED TO CONSTRUCT ROADWAYS.
 - CONTRACTOR SHALL PROTECT ALL SURVEY MONUMENTS. MONUMENTS SHALL BE LOCATED AND MARKED BY THE OWNER'S REPRESENTATIVE. MONUMENTS DISTURBED OR DESTROYED SHALL BE REPLACED BY THE OWNER'S REPRESENTATIVE AT THE CONTRACTOR'S EXPENSE.
 - THE CONTRACTOR SHALL REMOVE AND DISPOSE OF ALL ASPHALT PAVEMENT AND CURB & GUTTER TO A LEGAL OFF SITE LOCATION AS REQUIRED TO MAKE TIE-INS TO THE EXISTING STREETS.
 - THE CITY OF MANDAN WILL HIRE AN INDEPENDENT TESTING LABORATORY TO COMPLETE ALL REQUIRED TESTING. SCHEDULING AND COORDINATION OF ALL TESTING WILL BE THE CONTRACTOR'S RESPONSIBILITY.
 - WATER AND SEWER ON 34TH AVENUE AND 45TH STREET SHALL BE COMPLETED BY OTHERS PRIOR TO PAVING.

APPROXIMATE QUANTITIES

Paving Items	Quantity
Subgrade Prep	1824 SY
Watering	8 MGal
AC Stabilized Base	220 Ton
Asphalt Cement - Base (PG58-28)	14 Ton
AC Surfacing Course	176 Ton
Asphalt Cement - Surface (PG58-28)	11 Ton
Bituminous Tack Coat	80 Gal
Bituminous Seal Coat	539 Gal
Cover Aggregate	22 Ton
Blotter Aggregate	1 Ton
Curb and Gutter (Unreinforced)	752 LF

BOP 0+00.00
N 438445.63
E 1858619.18

CIRCULAR	CIRCULAR (FUTURE)	CIRCULAR (FUTURE)
Da 38°11'50" PI Sta 5+72.14	Da 09°03'05" PI Sta 6+67.91	Da 19°05'55" PI Sta 8+09.35
T 117.09 N 438251.88	T 14.02 N 438360.78	T 127.41 N 438474.65
R 150.00 E 1859157.52	R 633.00 E 1859230.54	R 300.00 E 1859314.44
L 198.84 I 75°56'59"L	L 28.04 I 02°32'17"R	L 240.98 I 46°01'24"L

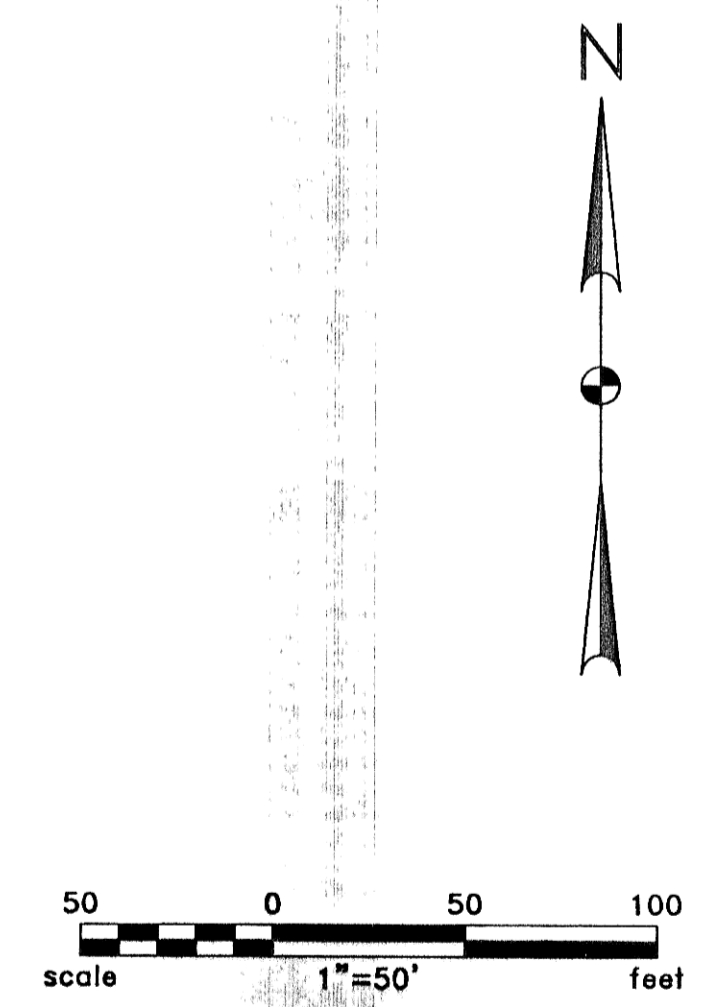
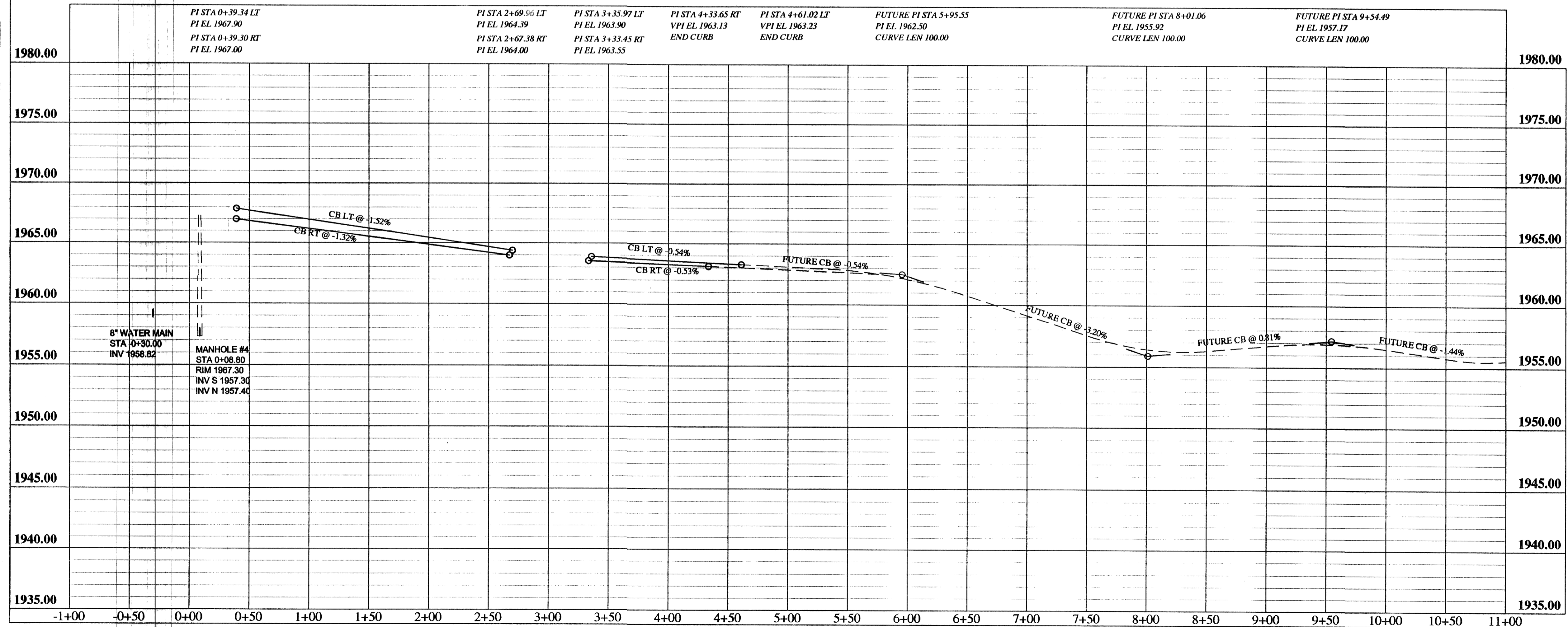

RECORD
DRAWING

Rev'd	MEADOWS 2ND ADDITION STREET IMPROVEMENT DISTRICT NO. 2005-28 MANDAN, NORTH DAKOTA	SHEET NO. 8
Kadmas Lee & Jackson Engineers Surveyors Planners	45TH STREET PLAN AND PROFILE	DATE 04/28/06
DOWN BY ADA	CHK'D BY BE	CMR. NO. 1406103
J:\municipal\1406103 - Meadows Streets\CADD\EP\RCP\45TH.dwg		
© Kadmas, Lee & Jackson, Inc. 2006		