

INSTALL CORRUGATED STEEL PIPE

121+00 Rt.	18" X 60'	131+00 Lt.	18" X 40'
123+56 Rt.	18" X 40'	128+20 Lt.	18" X 50'
125+20 Rt.	18" X 50'	132+75 Rt.	18" X 60'
128+20 Rt.	18" X 50'	135+00 Rt.	18" X 60'
126+90 Rt.	18" X 50'	132+75 Lt.	18" X 50'
130+10 Rt.	18" X 50'	131+27 Rt.	18" X 50'
125+20 Lt.	18" X 50'	131+90 Lt.	18" X 50'
130+10 Lt.	18" X 50'		

INSTALL PIPE CULVERT

128+20 E (Skew 34° Rt. & Ahd) 44" X 27" X 116' RCP Arch 31.1'

FED. AID PROJECT NO.	STATE	FED. AID PROJECT NO.	SHEET NO.	TOTAL SHEETS
8	N.D.	F-1094(03)	19	

BENCH MARK			
NO.	DESCRIPTION	LOCATION	ELEV.
9	Point Spot on R.C.B.	132+05-20 Rt.	1637.88

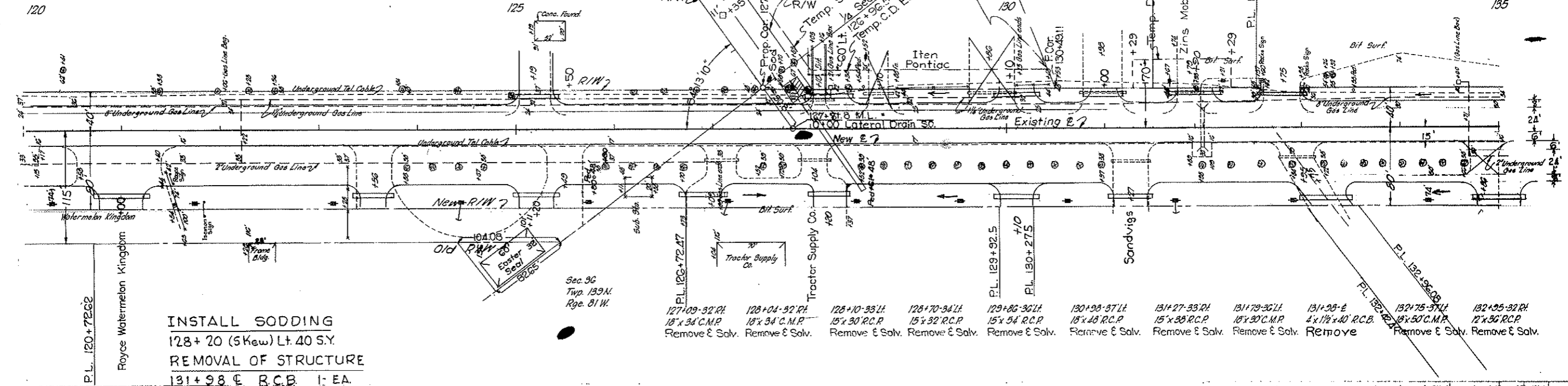

INSTALL SODDING
128+20 (Skew) Lt. 40 S.Y.
REMOVAL OF STRUCTURE
131+98.4 R.C.B. 1:EA.

127+09-32 Rt.	128+04-32 Rt.	128+10-33 Lt.	128+70-34 Lt.	129+86-36 Lt.	130+28-37 Lt.	131+27-33 Rt.	131+79-36 Lt.	131+98-E	132+75-37 Lt.	132+95-32 Rt.
18' X 34' C.M.P.	18' X 34' C.M.P.	15' X 30' R.C.P.	15' X 32' R.C.P.	15' X 54' R.C.P.	18' X 48' R.C.P.	15' X 30' R.C.P.	15' X 30' C.M.P.	4' X 1 1/2' X 10' R.C.B.	18' X 50' C.M.P.	12' X 30' R.C.P.
Remove & Solv.	Remove & Solv.	Remove & Solv.	Remove & Solv.	Remove & Solv.	Remove & Solv.	Remove & Solv.	Remove & Solv.	Remove	Remove & Solv.	Remove & Solv.

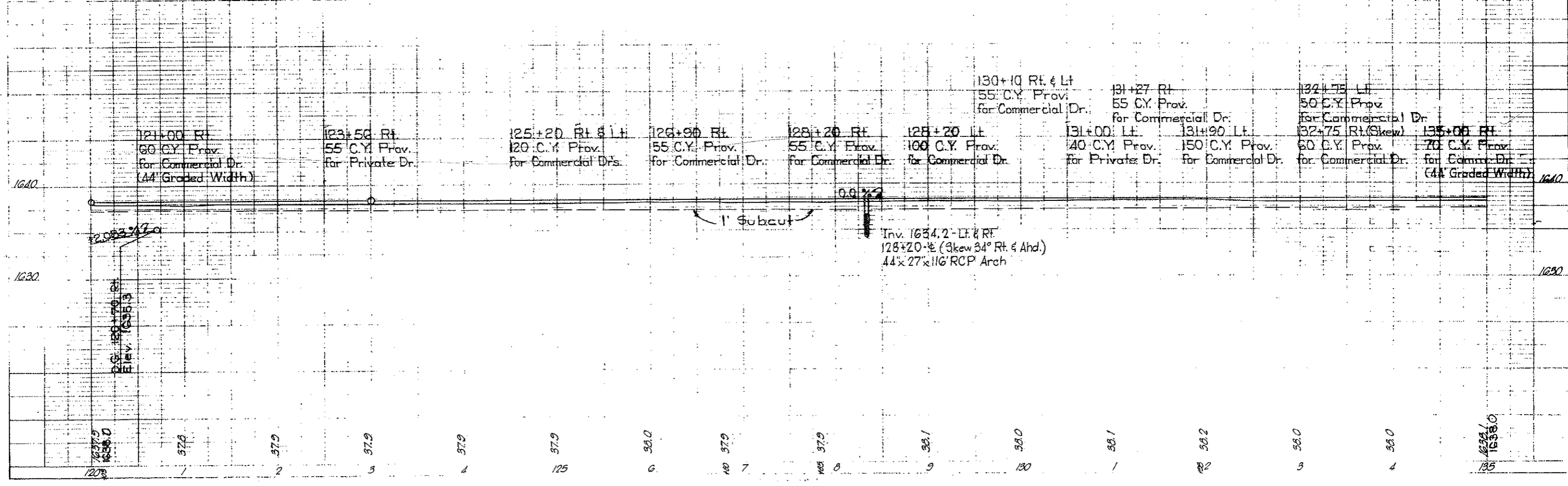

121+00 Rt.	123+56 Rt.	125+20 Rt. & Lt.	126+90 Rt.	128+20 Rt.	128+20 Lt.	130+10 Rt. & Lt.	131+27 Rt.	132+75 Lt.	135+00 Rt.
60 C.Y. Prov. for Commercial Dr. (44' Graded Width)	55 C.Y. Prov. for Private Dr.	120 C.Y. Prov. for Commercial Drs.	55 C.Y. Prov. for Commercial Dr.	55 C.Y. Prov. for Commercial Dr.	100 C.Y. Prov. for Commercial Dr.	55 C.Y. Prov. for Commercial Dr.	55 C.Y. Prov. for Commercial Dr.	50 C.Y. Prov. for Commercial Dr.	70 C.Y. Prov. for Commercial Dr. (44' Graded Width)

P.S. 126+70 Rt.
Elev. 1635.9

1637.9	37.9	37.9	37.9	37.9	38.0	37.9	38.1	38.0	38.0	38.0	38.0	38.1	38.2	38.0	38.0	1638.0
--------	------	------	------	------	------	------	------	------	------	------	------	------	------	------	------	--------