

**INSTALL CORRUGATED STEEL PIPE**

105+23 Lt. 18" X 50'	111+77 Lt. 18" X 60'
105+33 Rt. 16" X 50'	115+33 Rt. 50" X 31" X 50' Arch
109+00 Lt. 18" X 50'	117+67 Rt. 50" X 31" X 50' Arch
109+33 Lt. 18" X 50'	119+24 Rt. 50" X 31" X 50' Arch
115+33 Lt. 18" X 50'	
111+80 Rt. 18" X 60'	

FED. AID DIV. NO.	STATE	FED. AID PROJECT NO.	SHEET NO.	TOTAL SHEETS
8	N.D.	F-1-094(03)	18	

**BENCH MARKS**

NO.	DESCRIPTION	LOCATION	ELEV.
6	R.R. Spike in P.R.	106+73-145 Lt.	1640.95
7	Point Spot on R.C.B.	113+78-20 Rt.	1637.46
8	Point Spot on R.C.B.	119+93-20 Rt.	1637.81

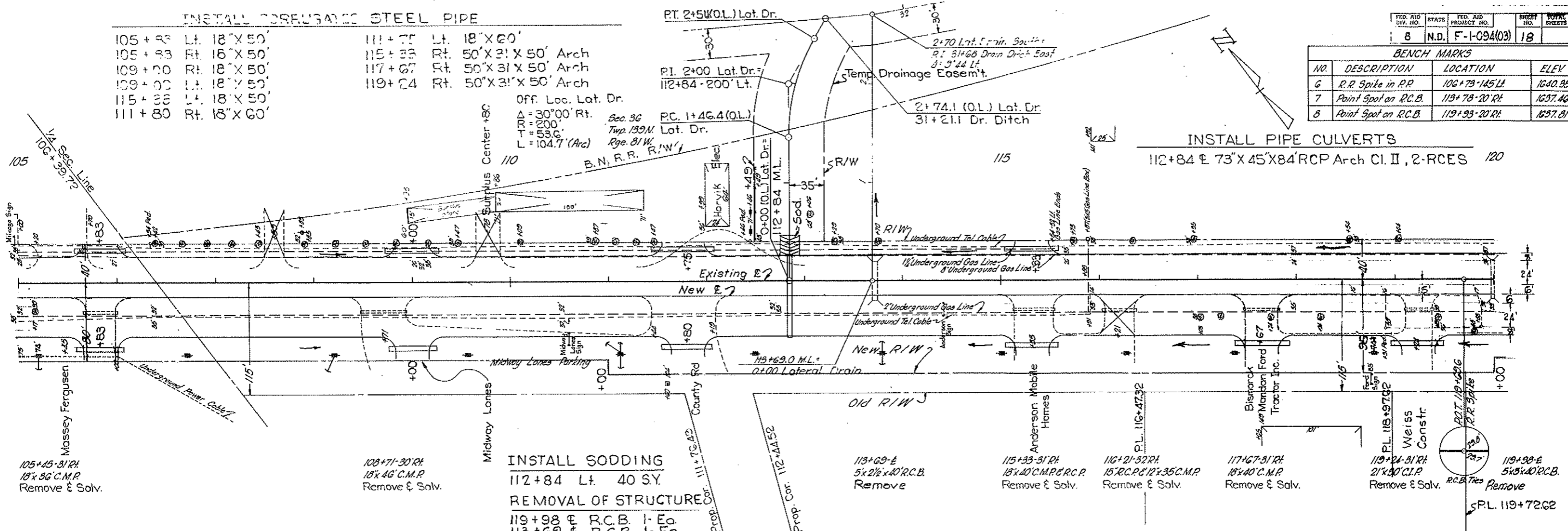

**INSTALL PIPE CULVERTS**  
 112+84 & 73" X 45" X 84' RCP Arch CI. II, 2-RCES 120

**INSTALL SODDING**  
 112+84 Lt. 40 S.Y.  
**REMOVAL OF STRUCTURE**  
 119+98 & R.C.B. 1-Eo  
 113+62 & R.C.B. 1-Eo

105+83 Lt. 55 C.Y. Prov. for Commercial Dr.	109+00 Rt. 55 C.Y. Prov. for Commercial Dr.	109+00 Lt. 55 C.Y. Prov. for Commercial Dr.	111+80 Rt. 100 C.Y. Prov. for Commercial Dr.	111+75 Lt. 65 C.Y. Prov. for Commercial Dr. (44' Gr. Width)	115+33 Lt. 50 C.Y. Prov. for Commercial Dr.	115+33 Rt. 150 C.Y. Prov. for Commercial Dr.	117+67 Rt. 150 C.Y. Prov. for Commercial Dr.	119+24 Rt. 150 C.Y. Prov. for Commercial Dr.
---	---	---	--	---	---	--	--	--

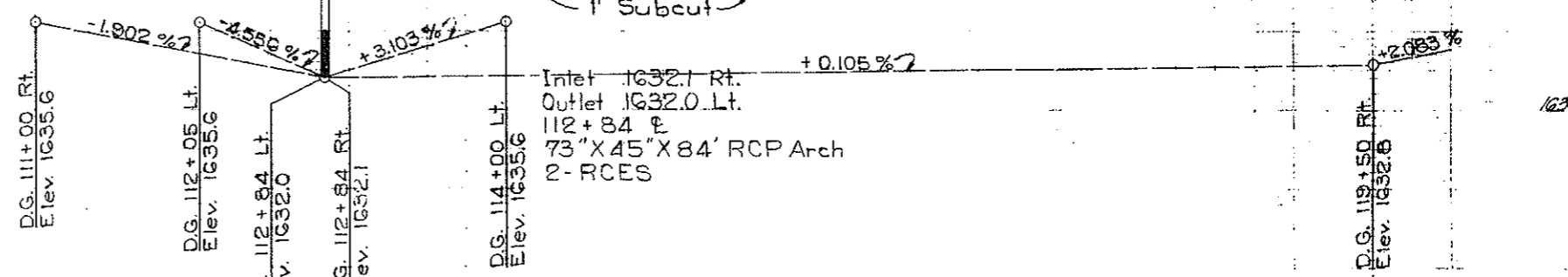
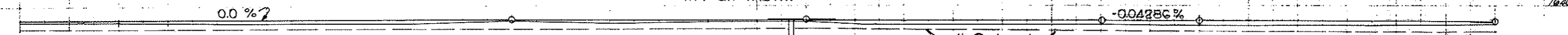

1638.3	38.3	38.2	38.2	38.4	38.2	38.5	38.0	38.2	38.0	38.1	38.1	38.1	1638.0
105	6	7	8	10	1	2	3	4	115	6	7	8	120