

FED. REGION	STATE	FED. AID PROJ. NO.	SHEET NO.
8	N.D.	MG-1-010(05)	21

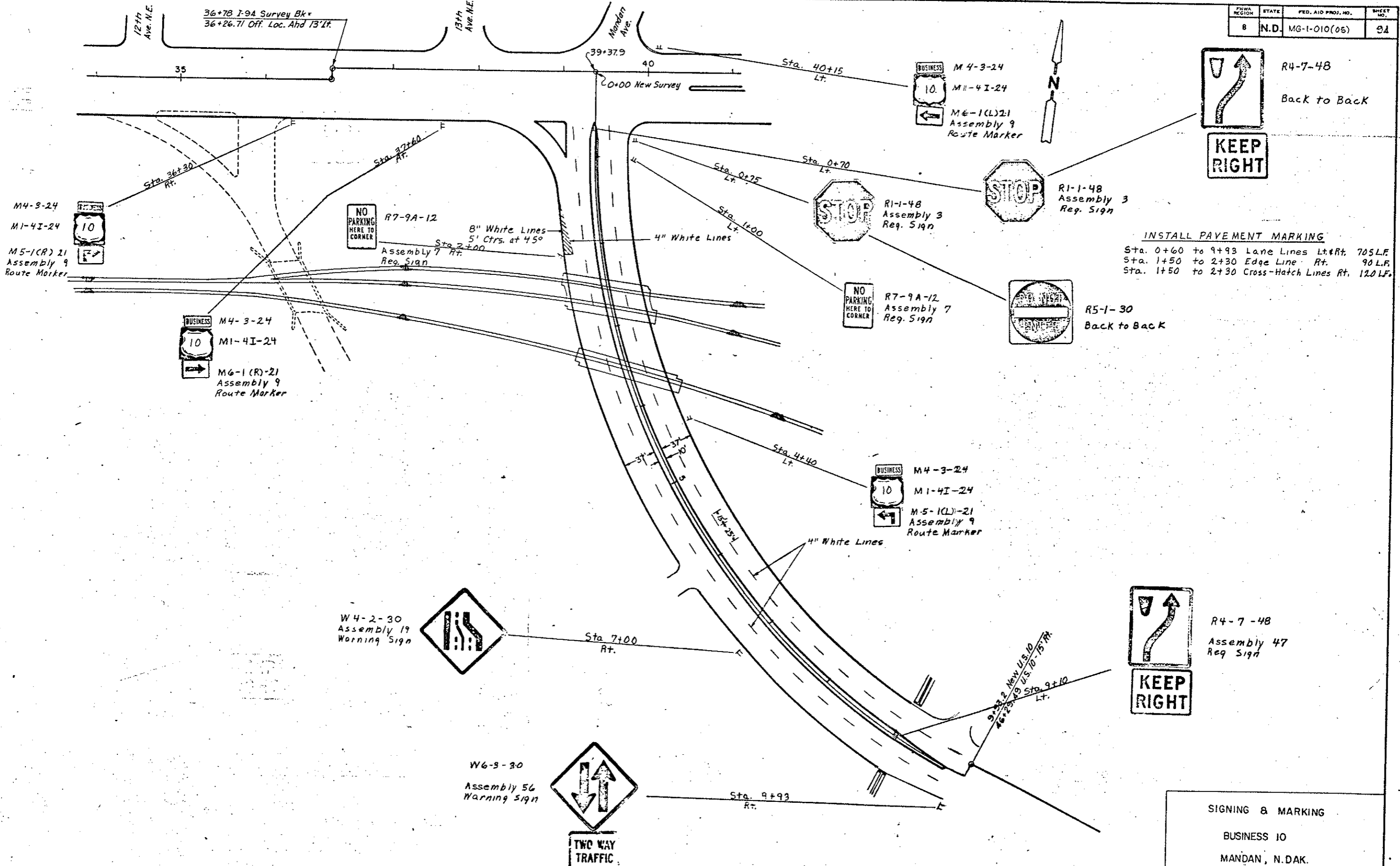

**INSTALL PAVEMENT MARKING**  
 Sta. 0+60 to 9+93 Lane Lines Lt&Rt, 705 LF.  
 Sta. 1+50 to 2+30 Edge Line Rt, 90 LF.  
 Sta. 1+50 to 2+30 Cross-Hatch Lines Rt, 120 LF.

**SIGNING & MARKING**  
 BUSINESS 10  
 MANDAN, N. DAK.